



CHEMICAL TREATMENT

WLMD receives a permit from DNR to chemically treat problem areas on Wind Lake. Most of the treated areas are shallow, weed-choked and restrict lake access. Studies show that early treatments are more effective at minimizing nuisance conditions using less chemicals, so we will be treating in early May, and early June, weather permitting. A reduced copy of the permit is provided in this newsletter. If you wish to see a full size copy, call 262-514-3238 and one will be provided.

If you DO NOT want your shoreline to be treated, please complete the form provided in this newsletter. Please return the form immediately.

When the treatment takes place, areas which are treated for algae, will not have posting signs. The shorelines treated for weeds will be posted with bright yellow signs, indicating what has been used and if there are any recreational use restrictions because of the treatment. The boat launch will also be posted with a treatment map.

Please don't assume we know how your shoreline has responded to a treatment. If conditions have changed, we may not know it. If the treatment wasn't effective, we won't know unless you tell us. And, let us know if you have had unusual weed problems. We will check it out. Please call or email with questions or concerns. As always, DNR has the final say in all the treatment areas for chemical control and may deny the treatment of specific areas.

ALGAE

Last summer was the 2nd year in a row that DNR denied some of our planned chemical treatments because they said we had blue green algae. Be aware that we may be denied treatments again this

year, especially if we have a lot of hot calm weather. If you see what looks like blue-green paint slime on the water, please avoid the area and keep your pets out of the water.

Although it is not an "algae" treatment, we are pursuing two grants (one State and one Federal) to assist with the funding of an Alum treatment in spring 2011. This project will reduce the nutrients in the lake, which will have the secondary affect of reducing algae.

GEESE

Wind Lake is in the eighth year of a program to reduce the numbers of geese on Wind Lake. This program has been very effective at reducing the numbers of non-migratory geese on the lake. The goose roundup will again take place in mid-June when the birds are without their flight feathers.

The goal of the program is to keep the numbers of geese in line with what the lake can support. Unfortunately, there are lots of geese nesting in surrounding areas, so we expect to have to conduct the removal for a number of years. The geese contribute to the water quality problems, including E-coli bacteria and increased phosphorus loadings.

Because most of the residents support this activity, we are changing up the notification process this year. **If you DO NOT want to allow us access to your shoreline area to remove the geese, please send in the form as soon as possible.** Thanks for your participation.

HARVESTING

The WLMD plans to conduct harvesting on the lake in mid-June and mid-July as conditions warrant. The past few years, harvesting has been used to open

**Chemical Aquatic Plant Control
Application and Permit**
Form 3200-004 (R 6/05) Page 1 of 4

DNR Use Only	
ID Number	
Waterbody #	
Permit Expiration Date	
Fee Received	

Notice: Use of this form is required by the Department for any application filed pursuant to s. 281.17(2), Wis. Stats., and Chapter NR 107, Wis. Adm. Code. The Department will not consider your application unless you complete and submit this application form. Personally identifiable information on this form may be provided to requesters as required by Wisconsin's Open Records law [ss. 19.31-19.39, Wis. Stats.].

Section I - Applicant Information

Name of Permit Applicant. Also indicate names and addresses of all individuals, associations, communities or town sanitary districts sponsoring treatment. Attach additional sheets if necessary:

Name <u>Wind Lk Mngt District</u>		Name	
Street or Route <u>30910 Royal Hill</u>		Street or Route	
City <u>Burlington</u>		City	
State <u>WI</u>	ZIP Code <u>53105</u>	State	ZIP Code
Telephone Number (include area code) Home: <u>262 514 3234</u> Business:		Email Address	
Lake:			

Section II - Aquatic Plant Control Location

Waterbody to be Treated (waterbody where treatment area is located) <u>Wind Lake</u>				Lake Surface Area <u>936</u> acres	Estimated Surface Area that is 10 Feet or Less in Depth _____ acres
County <u>Racine</u>	Section <u>4</u>	Township <u>N</u>	Range <u>20</u>	Adjacent Riparian Property Owner Names (attach sheets if necessary)	
Name of Applicator or Firm <u>Marine Biochemists</u>				1. <u>SEE Attached</u>	
Street or Route <u>6316 W. Eastwood Ct # 108</u>				2. _____	
City <u>Mequon</u>				3. _____	
State <u>WI</u>				4. _____	
ZIP Code <u>53092</u>				5. _____	
Telephone Number (include area code) Home: <u>262</u> Business: <u>3380406</u>				6. _____	
Email Address				7. _____	
Name of Lake Property Owners' Association Representative or Lake District Representative (if none, please indicate)					

Applicator Certification Number for Category 5 Aquatic Pesticide Application <u>Brian Suffern # 1517</u>	Date Verified w/ DATCP	Certification Expiration
Business Location License Number (if applicable) <u>93-000527</u>	Date Verified w/ DATCP	Certification Expiration
Restricted Use Pesticide License Number (if applicable)	Date Verified w/ DATCP	Certification Expiration

Area(s) Proposed for Control (Note details in permit cover letter for final permitted sizes of treatment areas.)

A. Shoreline Length _____ ft. X Distance From Shore _____ ft. + 43,560 ft. = _____	Estimated Acreage	Average Depth _____ ft.
B. Shoreline Length _____ ft. X Distance From Shore _____ ft. + 43,560 ft. = _____	Estimated Acreage	Average Depth _____ ft.
C. Shoreline Length _____ ft. X Distance From Shore _____ ft. + 43,560 ft. = _____	Estimated Acreage	Average Depth _____ ft.
D. Shoreline Length _____ ft. X Distance From Shore _____ ft. + 43,560 ft. = _____	Estimated Acreage	Average Depth _____ ft.
E. Shoreline Length _____ ft. X Distance From Shore _____ ft. + 43,560 ft. = _____	Estimated Acreage	Average Depth _____ ft.
Total Estimated Acreage <u>65 acres</u>		

If the estimated acreage is greater than 10 acres, or is greater than 10 percent of the estimated area 10 feet or less in depth in Section II, complete and attach Form 3200-004A, Large-Scale Treatment Worksheet. Private pond treatments are exempted from this requirement.

Is this area within or adjacent to a sensitive area designated by the Department of Natural Resources? Yes No

NHI Review? Yes No Describe:

Section III - Fees

- s. NR 107.11(1), Wis. Adm. Code, lists the conditions under which the permit fee is limited to the \$20 minimum charge.
- s. NR 107.11(4), Wis. Adm. Code, lists the uses that are exempt from permit requirements.
- s. NR 107.04(2), Wis. Adm. Code, provides for a refund of acreage fees if the permit is denied or if no treatment occurs.
- Fee calculations:

Basic Permit Fee (non-refundable)	\$ 20.00
If proposed treatment is over 0.25 acre, calculate acreage fee: (round up to nearest whole acre, to maximum of 50 acres.)	
<u>65</u> acres X \$25 per acre = \$ _____	
If proposed treatment is ≤ 0.25 acre, acreage fee is \$0.	
Enter Acreage Fee (from above)	<u>1250</u>
Total Fee Enclosed	\$ <u>1270</u>

Please include a sketch and/or a printed map of lake indicating area and dimensions of each individual area where plant control is desired. Also show location of property owners riparian to and adjacent to the treatment area. You may use the space below to sketch a map. Attach a separate list of owners and corresponding treatment dimensions coded to the lake map, if necessary.

Section VI - Applicant Responsibilities and Certification

- The applicant has prepared a detailed map which shows the length, width and average depth of each area proposed for the control of rooted vegetation and the surface area in acres or square feet for each proposed algae treatment.
- The applicant understands that the Department of Natural Resources may require supervision of any aquatic plant management project involving chemicals. Under s. NR 107.07, Wis. Adm. Code, supervision may include inspection of the proposed treatment area, chemicals and application equipment before, during or after treatment. The applicant is required to notify the regional office 4 working days in advance of each anticipated treatment with the date, time, location and size of treatment unless the Department waives this requirement. Do you request the Department to waive the advance notification requirement? Yes No
- The applicant agrees to comply with all terms or conditions of this permit, if issued, as well as all provisions of Chapter NR 107, Wis. Adm. Code. The required application fee is attached.
- The applicant has provided a copy of the current application to any affected property owners' association, inland lake district and, in the case of chemical applications for rooted aquatic plants, to all owners of property riparian or adjacent to the treatment area. The applicant has also provided a copy of the current chemical fact sheet for the chemicals proposed for use to any affected property owner's association or inland lake district.

I hereby certify that the above information is true and correct and that copies of this application have been provided to the appropriate parties named in Section II and that the conditions of the permit and pesticide use will be adhered to.

Signature of Applicant: [Signature] Date Signed: 3-4-10

All portions of this permit, map and accompanying cover letter must be in possession of the chemical applicator at time of treatment. During treatment all provisions of Chapter NR 107, specifically ss. NR 107.07 and NR 107.08, Wis. Adm. Code, must be complied with, as well as the specific conditions contained in the permit cover letter.

Section VII - Permit to Carry Out Chemical Treatment (Leave Blank - DNR Use Only)

The foregoing application is approved. Permission is hereby granted to the applicant to chemically treat the waters described in the application during the season of 20____.

Application fee received? <input type="checkbox"/> Yes <input type="checkbox"/> No	State of Wisconsin Department of Natural Resources For the Secretary
Advance notification of treatment required? <input type="checkbox"/> Yes <input type="checkbox"/> No	By _____ Regional Director or Designee
	Date Signed _____ Date Mailed _____

Please Note:

If you believe that you have a right to challenge this decision, you should know that Wisconsin statutes and administrative rules establish time periods within which requests to review Department decisions must be filed.

For judicial review of a decision pursuant to ss. 227.52 and 227.53, Wis. Stats., you have 30 days after the decision is mailed or otherwise served by the Department, to file your petition with the appropriate circuit court and serve the petition on the Department. Such a petition for judicial review shall name the Department of Natural Resources as the respondent.

This notice is provided pursuant to s. 227.48(2), Wis. Stats.

To request a contested case hearing pursuant to s. 227.42, Wis. Stats., you have 30 days after the decision is mailed, or otherwise served by the Department, to serve a petition for hearing on the Secretary of the Department of Natural Resources. The filing of a request for a contested case hearing is not a prerequisite for judicial review and does not extend the 30-day period for filing a petition for judicial review.

**Chemical Aquatic Plant Control
Application and Permit**

Form 3200-004 (R 6/05) Page

Section IV - Reasons for Aquatic Plant Control

Goal of Aquatic Plant Control:

- Reduce nuisance algae accumulation
- Maintain navigational channel for common use
- Maintain private access for boating
- Maintain private access for fishing
- Improve swimming
- Control of purple loosestrife
- Other: _____

Nuisance Caused By:

- Algae
- Emergent water plants (majority of leaves and stems growing above water surface, e.g. cattails, bulrushes)
- Floating water plants (majority of leaves floating on water surface, e.g., waterlilies, duckweed)
- Submerged water plants (leaves and stems below water surface, flowering parts may be exposed, e.g., milfoil, coontail)
- Other: _____

List Target Plants

*milfoil
filamentous algae
Curly Leaf Pondweed
Chara Water Lilies, Elodea Coontail*

Note: Different plants require different chemicals for effective treatment. Do not purchase chemical before identifying plants.

Section V - Chemical Control

Alternatives to Chemical Control:

	Feasible?	If No, Why Not?
1. Mechanical harvesting	<input type="checkbox"/> Yes <input checked="" type="checkbox"/> No	<i>no depth</i>
2. Hand pulling	<input checked="" type="checkbox"/> Yes <input type="checkbox"/> No	<i>ongoing</i>
3. Hand raking	<input checked="" type="checkbox"/> Yes <input type="checkbox"/> No	<i>u</i>
4. Hand cutting	<input checked="" type="checkbox"/> Yes <input type="checkbox"/> No	<i>u</i>
5. Sediment screens/covers	<input type="checkbox"/> Yes <input checked="" type="checkbox"/> No	<i>no depth</i>
6. Dredging	<input type="checkbox"/> Yes <input checked="" type="checkbox"/> No	<i>not feasible</i>
7. Lake drawdown	<input type="checkbox"/> Yes <input checked="" type="checkbox"/> No	<i>not feasible</i>
8. Nutrient controls in watershed	<input checked="" type="checkbox"/> Yes <input type="checkbox"/> No	<i>ongoing</i>
9. Other: _____	<input type="checkbox"/> Yes <input type="checkbox"/> No	

Note: If proposed treatment involves multiple properties, consider feasibility of EACH alternative for EACH property owner.

If you checked yes to any of the alternatives listed above, please explain your decision to use chemical controls:

Insufficient to achieve control

Trade Name of Proposed Chemical(s)

Navigate, Citrine Plus, Cleargate DMA-4, Aquathol K, Reward

Method of Application

Spreader & Sprayer

Which chemicals or other control options have been tried before on the proposed site, and what were the results?

all of the above - effective

Note: Chemical fact sheets for aquatic pesticides used in Wisconsin are available from the Department of Natural Resources upon request.

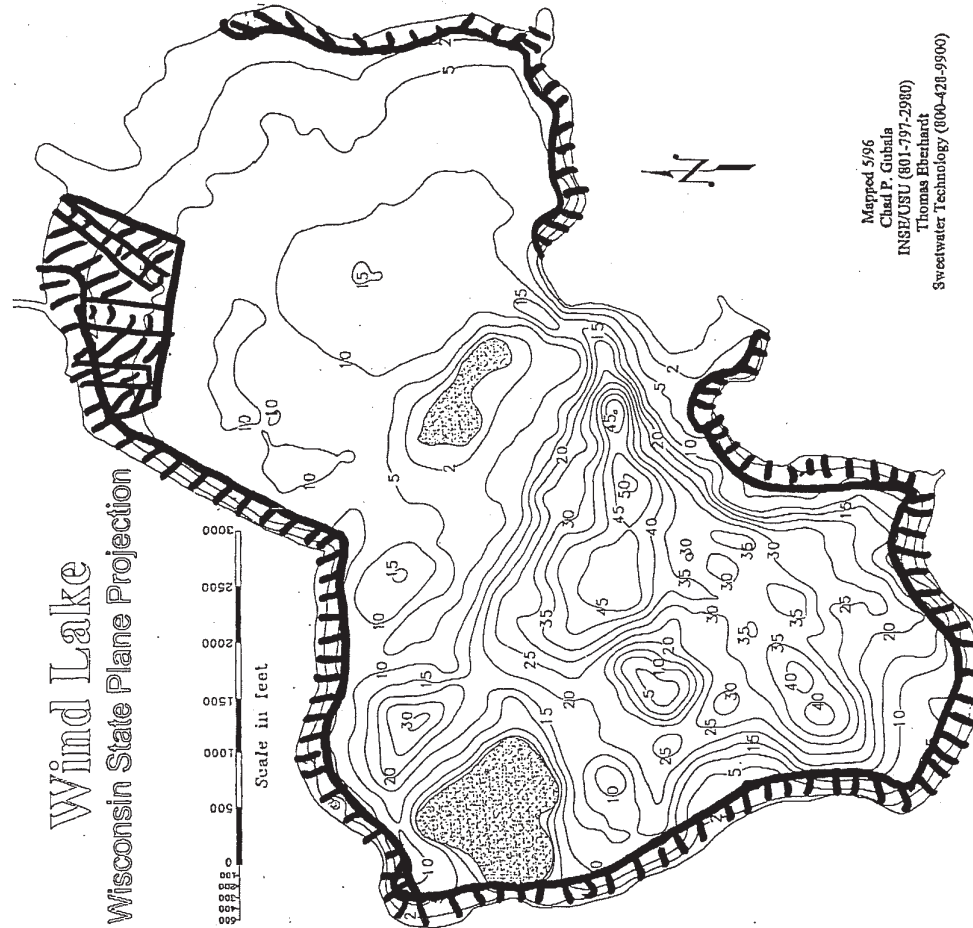

Mapped 5/96
Chad P. Gubala
INSD/USU (801-797-2980)
Thomas Eberhardt
Sweetwater Technology (800-428-9900)

up navigational channels on the lake. The Town has worked with us by allowing the cut weeds to be dumped at the old Transfer site. We now have a 5-year DNR permit to conduct harvesting on Wind Lake.

LEGAL NEWS

The WLMD is involved in two legal actions that could affect the lake level. The Norway Dover Drainage District is appealing the DNR denial to lower Wind Lake in winter. The other case is a lawsuit involving a sod farmer who is suing us because he believes the WLMD caused his flooding and subsequent loss of crops. The WLMD insurance is defending us in the case with the sod farmer.

BOARD OF COMMISSIONERS

Jim Marks	895-7872
Mike Benish	c/o 514-3238
Richard Mohr	895-7927
Joe Bellante	895-2909
Ralph Schopp	414-531-6020
Lake District Line	514-3238

Commissioners meetings are usually held the 4th Thursday of every month, with the November and December meeting combined. Meetings begin at 7:30 pm at the Norway Town Hall. Everyone is welcome to attend.

NEED MORE INFO?

If you do, check out our website. The site has:

- meetings, schedules, agendas, and minutes
- links to other lake-related sites
- information about who to contact for various activities
- the latest lake depth map of Wind Lake
- other special notices as needed are also posted on the site.

WIND LAKE WEBSITE

www.windlake.org

www.wlmd.org

DISTRICT EMAIL

info@wlmd.org

ADDRESS SERVICE REQUESTED

Wind Lake Management District
30910 Royal Hill Rd.
Burlington, WI 53105

CHEMICAL TREATMENT REJECTION FORM - 2010

If you **DO NOT** want your shoreline to be treated, you must return this form as soon as possible.

I hereby request that my shoreline NOT be chemically treated. I understand that NOT treating my shoreline will NOT reduce my annual tax.

Name (PRINT) _____

Address _____

Phone _____

Lake Address (if different) _____

Tax Key Number _____

Signature (Mandatory) _____

This form must be returned by April 30, 2010!

Send to: WLMD, 30910 Royal Hill Rd., Burlington, WI 53105

GOOSE ROUNDUP DENIAL FORM - 2010

DO NOT enter onto my property to catch geese.

Name (PRINT) _____

Lake Address _____

Phone _____

Signature (Mandatory) _____

Please return form as soon as possible, no later than June 1, 2010!

Send to: WLMD, 30910 Royal Hill Rd., Burlington, WI 53105